

PART C

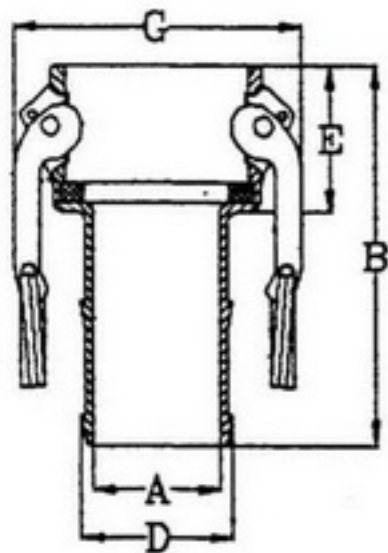

Size	1/2"	3/4"	1"	1-1/4"	1-1/2"	2"	2-1/2"	3"	4"	6"
Size of Thread	1/2"	3/4"	1"	1-1/4"	1-1/2"	2"	2-1/2"	3"	4"	6"
G: Max O.D.	45.7	53.3	60.9	82.6	90.3	99.8	112.4	137.6	165.6	238.3
B: Overall Length	87	82.8	96.2	102.5	104	129	142.3	157.1	163.5	229
E: Exposed Length	31.4	32	39	44.5	45	50	54.3	55.5	55.5	65.5
A: Min. I.D.	7.7	13.8	19.8	25.9	32.3	44.5	56.7	68	93.4	144.8
D: Shank O.D.	14.6	21	27	33.7	40.1	52.7	66.3	79	104.4	156.8

unit:mm